



Bethany Lutheran Church and Early Childhood Center

October 2023

Bethany Lutheran Church
 1000 W. 26th Street South
 Wichita, KS 67217
 Church Phone 316-265-7415
 BECC Phone 316-265-3033
 www.bethanylutheranwichita.org

Worship Service
 Sunday - 9:00 AM
 ECC chapel -
 Wed.- 9:15 AM
**Sunday School &
 Adult Bible Study**
 Sunday - 10:30 AM
 Pastor:
 Nicholas Cordt

Early Childhood Center
 Serving children ages
 One through Five
Program Director
 Danita Seamars
 316-265-3033

October 2023

S	M	T	W	T	F	S
1	2	3	4	5	6	7
8	9	10	11	12	13	14
15	16	17	18	19	20	21
22	23	24	25	26	27	28
29	30	31				

I could have sworn I just finished typing my article for **September's** newsletter a few days ago. So much has happened in **ONE** month! **Blink.** It's **October!** To highlight what's been going on:

- By the grace of God, over \$71,000 of the over \$88,000 that was pledged has come in (see graph below).
- We broke ground on Sep. 10th (see page 9 for pics).
- The new driveway was poured Sep. 14th (see page 4).
- The 5 wrought iron fence sections were sandblasted and powder coated. They look better than new and were re-installed Sep. 26th (see page 4).
- Additional signage was installed to help our guests and visitors more easily navigate the building (see below).

God's been doing some amazing things but there is still more to come:

- The sprinkler system is going to be installed in the next week or two.
- Once the sprinkler is installed, we'll be doing some new landscaping to help increase our curb appeal.
- We're still working with LED sign companies to finalize a bid and hope to have the new LED sign installed before Christmas.
- Plans are happening to remodel the Toddler/Preschool 1 rooms so our ECC is able to accept infants (see plan below).

September 12th marked six months since I was installed as your pastor. In those six months, God and this congregation have repeatedly surpassed even my optimistic expectations. I'm not even going to try and speculate what I might write for my March 2024 newsletter article because (as history has proven) He has something even better in mind. Keep those seatbelts fastened as we 'Fulfill The Dream and Continue The Legacy'.

Your fellow servant on the journey,
 ~Pastor Nick

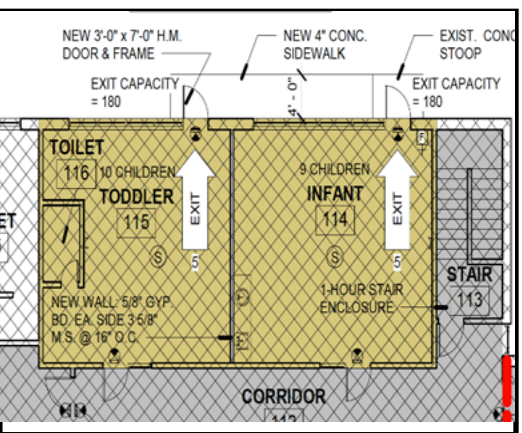
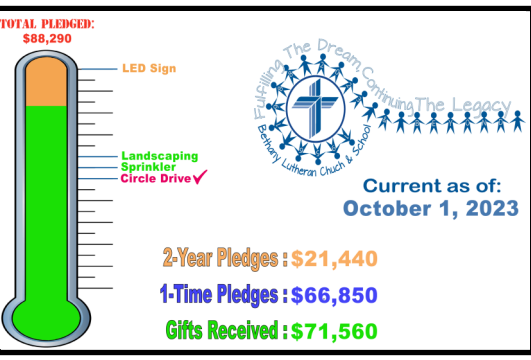

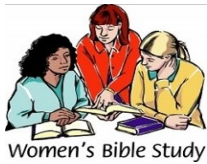

Women's Bible Study meets on the **1st & 3rd Thursdays of the month at 7:00 p.m. at Bethany.** Current study is "All Things New, A Study on 2 Corinthians" from The Living Room Series by Kelly Minter. See Jenny Colby or Doris Cannon for more information. Come and join us and bring a friend.

Pastoral Visits and Contact: Pastor Nick Cordt is delighted to visit: to get acquainted, have devotion and prayer, and talk and pray over matters of concern in life. Please, feel free to contact the church office between 9:00am and 5:00pm, Monday through Friday, to arrange a day and time to do so. If Pastor is not available at the time you call, leave a message with the office secretary, David Funke or send an email to pastornick@bethanylutheranwichita.org



Seniors' Activities: Breakfast: Meets on the 3rd Wednesday at 9:00am at Country Café, 2804 S. Seneca. **"God's People: Walking and Talking":** Mondays, Wednesdays & Fridays: 1:00-2:00pm, in the Activity Center and the Dining Room.

Westside UMC Food Pantry: We are still collecting non-perishable food items for Westside United Methodist's food pantry. If you would like to donate, place items in the tub beneath the "Food Contributions" sign located in the hall between the office and Library at Bethany.

Chamberlin, Kim L.	10/2
Ferrell, Caleb J.	10/2
Albright, Annetta S.	10/4
Edgar, Kelsea N.	10/4
Dunkel, Jodee D.	10/6
Rowley, Jazmin	10/6
Horn, Alicia J.	10/7
Mann, Andrew M.	10/7
Dehncke, Alyssa D.	10/8
Parmenter, Lynsi B.	10/8
Jahnke, Michael D.	10/9
Laska, Dastyn M.	10/9
Jones, Jamil	10/11
Albright, Annette	10/12
Karnes, Joseph P.	10/12
Albright, Anita L.	10/13
McMullin, Madison R.	10/14
Schreffler, Melanie	10/14
Parmenter, Katie L.	10/15
Arnett, Logan D.	10/17
Chamberlin, Cole C.	10/27
Nienke, Steven A.	10/31



Welty, Samantha	10/1
Ferrell, Caleb J.	10/2
Studtmann, John M.	10/2
Vinroe, Hailey N.	10/2
Cox, Lisa M.	10/4
Moore, Larry D.	10/4
Walsh, Crystal M.	10/14
Funke, David C.	10/17
Young, Jamie R.	10/19
Zindel, Ashlee L.	10/24
Zindel, Troy A.	10/24
Merrick, Jimmie L.	10/25
Salazar, Amy J.	10/26
Schott, Cody E.	10/28
Stanberry, Owen N.	10/28
Albright, Debra S.	10/31

Valdez, Ramon E. and Ruth M.	10/10	15 yrs.
Shipman, Richard D. and Stacy R.	10/14	23 yrs.
Storck, Junior L. (Junior) and Shirley J. (JoAnn)	10/14	67 yrs.
Swiggart, Matthew L. and Melissa A.	10/27	33 yrs.



Greeters

October

- 1: Anita Albright
- 8: Netta Albright
- 15: Margaret Baldrige
- 22: Billy & Toni Bolin
- 29: Robert & Jeanetta Bolin

November

- 5: Lois Brockmeyer
- 12: Jim & Vera Brummett
- 19: Doris Cannon
- 26: Jenny Colby

You are the first point of contact for our guests! Welcome them by smiling. If this is their first visit to our church, thank them for joining us in worship. Alert one of our ushers that they are first time visitors so that any questions regarding our service can be answered. If you cannot be greeter on the Sunday you have, please talk to Doris Cannon and she will contact someone else. If you would prefer not to be a greeter, please tell Doris .

Children's Sunday School Teaching Schedule

Opening in the back of the Sanctuary, class following and Activity time in Youth room in basement



October 1	Deb Welty	November 5	Ruth Valdez
October 8	Ruth Valdez	November 12	Deb Welty
October 15	Deb Welty	November 19	Ruth Valdez
October 22	Ruth Valdez	November 26	Deb Welty
October 29	Deb Welty		

Altar Guild



Fill

Sept. 3 & Oct. 1	Margaret Baldrige & Marcia Hampton
Sept. 10 & Oct. 8	Doris Cannon
Sept. 17 & Oct.15	Lois Adams & Amy Salazar
Sept. 24 & Oct.22	Doris Cannon
Oct.29	Robert Ohmie

Cleanup

Vicki Pasewark
Toni Bolin
Julie O'Brien
Rhonda Dehncke & Vivian Mailly
Melanie Schreffler & Fern Neumiller

Anyone who would like to help with Altar Guild, please contact Doris Cannon.



Head Usher – Alan Keimig

October

- Bruce Kester
- Doug Meyer
- Roger Obermueller

November

- David Funke
- Larry Moore
- Erich Schieber

If you cannot be usher on the Sunday/month you have been assigned, please talk to Alan Keimig. If you would prefer not to be an usher, please tell Doris Cannon. Or if you would like to be an usher and you're not on the list, contact Doris.



October

- 1: Richard Vinroe / Mark Welty
- 8: Mike Parmenter / Robert Ohmie
- 15: Robert Bolin / Jim Merrick
- 22: Richard Vinroe / Mark Welty
- 29: Mike Parmenter / Robert Ohmie

November

- 5: Robert Bolin / Jim Merrick
- 12: Richard Vinroe / Mark Welty
- 19: Mike Parmenter / Robert Ohmie
- 26: Robert Bolin / Jim Merrick



There is a lot of **behind the scenes work** that is done for our *worship services, Bible Studies, Children's and Youth Ministries, greeters, ushers, altar guild, music ministry*, and so many more ministries that we need help with. Most of these do not take much time out of our busy schedules to be part of. **Is God calling you to be part of something but you don't know where to start?** Be an usher! Prepare the communion! These are very important jobs that only require a little bit of you. Please contact an elder listed in this newsletter to see where YOU can be of service to God's kingdom.

Spiritual Leadership Report

We remember those families that have lost loved ones! We pray for healing and strength to those in need. We are ever thankful for our members with giving hearts to continue His work at Bethany! Thankful for Pastor Nick and his guidance to keep Bethany on the cutting edge of visibility in the community! We see relationships renewed from past members/children.

Thank God!! After all.. WE ARE STILL HERE!!

Peace, SLT

Trustees Report

Many thanks to the specialists that made short work of leveling the dirt and doing some landscaping! Ready for the sprinkler system!! It looks GREAT!!

We hope to be out of A/C need soon. Point...one of the four A/C units for the sanctuary needs to be replaced. We plan to hold off the replacement until early spring. Costs today are in the \$8,000 range. We hope to get better pricing in the off season. Please note, this is something we need to include in the '24 work program or fund separately.

You will note work in the courtyard... Stone caps and sills cleaned. Iron fence powder coated. On going trimming/caring for plants and shrubs. Thankful for the donated funds and volunteers that make things work!

We have had multiple acts of vandalism in our parking lot. At this time, we are not replacing the signage. Seems that we are on a possible "Tik-Toc" circuit... So, we are not willing to keep replacing signs to be targets. Police reports have been filed.

All for now, Trustees

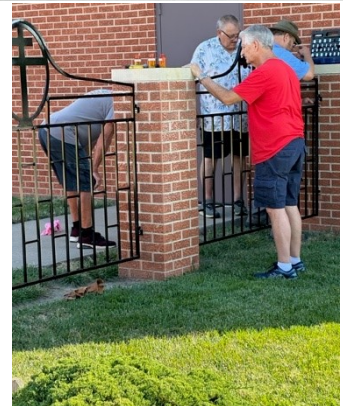

Sunday Happenings

Service 9:00 AM / Fellowship Time 10:00 to 10:30 AM / Sunday School/Bible Study 10:30-11:30 AM

PRAYER CENTER - Robert Bolin leads a study on how the Lutheran Church differs in its understanding of the Sacrament of Communion from other Christian groups and on what biblical writings that understanding is based.

MEET & EAT ROOM- Mark Dehncke's class is reviewing Luther's Small Catechism. Note the classroom location change. By the way, if you have ever wondered why this book is called a catechism, the reason is the word comes from the Greek verb "katecho" - "to teach orally".

ACTIVITY CENTER- Pastor Nick leads a class. Topic changes weekly.

YOUTH AND KIDS - SUNDAY SCHOOL includes ages Preschool to age 17. Teachers are Ruth Valdez and Deb Welty with assistance of Tonya Cordt. An opening is held at 10:30 in the back of the Sanctuary with music led by Sandy Tope. Lesson and activity is in the Youth Room in basement.





Early Childhood Center Update

Life is good in our ECC Daycare! Enrollment is steady, but could be better, running in the 30-something range. With our current staffing, we can take about 10 more kids at any time, to fill to our capacity of 44. Our numbers always fluctuate, as that is how daycare is everywhere...people's needs for services come and go.

Grant applications: We now have 3 grants that we have applied for. We hope to tell you next month exactly what we will get. The grants are: 1) A \$7,200 grant for general expenses, to offset the cost of caring for the children whose tuition is paid by DCF. About half of our families receive DCF funding, so the \$7,200 is what the State figures we deserve. This grant is from Child Care Aware, using Kansas DCF money. 2) A grant for \$9,756 to pay for cribs and rockers for our new Infant Room and fliers and supplies for our ECC family night festivities we hold several times a year. This grant is from our LCMS Kansas District, using money from our fellow Lutherans. 3) A grant for \$78,206 for operational costs for expanding our Daycare by 31 slots for children. This grant is for staff, training, advertising and supply costs only, and cannot be used for construction. This grant is from the Kansas Children's Cabinet and Trust Fund, a public-private consortium. If approved, we would spend this money to pay for the 5 new Teacher jobs, 3 being in our soon-to-open Infant room and 2 in our older-age classrooms. These 5 positions, when filled, would allow us to add the 9 infants we are planning on (1 Teacher for each 3 babies) and 10 more kids in each of the 2 oldest age groups. This would fund the new jobs until June of next year, when the grant ends. We already have one Infant Teacher ready to go, and we would have to newly hire the others.

That's it for now, but keep watching - things are Happening at Bethany and in our Daycare!!

Thank you for your continued prayers and support;
For the ECC Team, Jim Merrick



The PreK class helped the church ladies quilting group pack school bags for kids in other parts of the world. The kids really enjoyed helping.



Getting ready for spooky season. Fun sensory play.

Bike Ride:

We had a great day for our September bike ride. We met at the park in downtown Goddard and rode to Garden Plain and back for a total distance of twelve miles. We had 12 riders attend. Visitors were: Jeff and Marsha, Dale and Jamin, Jaxon, Byron, Crystal and Chance. Riders from Bethany were: Mark and Debbie, Robert and Alan. Everyone had a good time. Our next ride will be Oct. 29th at Sedgwick County Park, 4:00pm. Meet in the South parking lot.





Our Garden Continues to Do Well!

The race is on! Will the plants mature before the first frost which is October 21st for our area. Who knows what the outcome will be. Let's hope and pray the cantaloupes and the watermelons win the race. It's all about timing and the weather.

It has been a blessing and a joy for three years now, being dedicated to Bethany's Garden and I hope for many more years! Thank you all for the opportunities to serve Bethany as we travel this journey together! Vicky Collins: 316-771-1207



Have had the opportunity to engage thousands of students with the Gospel of Jesus and opportunities to grow in faith and Christian community! Call for more information: 316-684-5224 / 3815 E. 17th St. N. / Wichita, KS 67208 Learn more at www.fairmountministries.org.

The "College Age Bible Study" meets every Tuesday from 7:00-8:30pm. The "Young Adults" group meets on Sundays from 6:00 to 7:30pm.

BLESSL

(Bethany Lutheran English Studies as a Second Language): We are currently teaching a Sunday evening and a Friday evening class at 6:30pm. Vicky Collins is teaching a Thursday afternoon class in a woman's home on Thursday at 1:00pm. If you know someone who is looking for free English instruction and is free at those times, let them know about the Bethany classes.



Southwest Neighborhood Association meets the fourth Tuesday of the month, 7pm at Bethany. We look forward to seeing you and bring a neighbor or two. There is plenty of room.

More information: contact Darlene Nuse www.southwichta.com

Stewardship Report: Here are the latest budget figures through August. In August we didn't receive any grant funds but what we have received this year should easily keep us in the black for 2023. The bottom line is we need those extra funds to help us break even. Look for information soon about 2024 Budget.

Time
Talents
Treasure

Thanks to all who help with various things at the church. Many help! All is very much appreciated!

	2023	MAR	APR	MAY	JUN	JUL	AUG	Line Total	8 mo budget
BASE OPERATIONS		\$20,871	\$12,323	\$14,604	\$13,099	\$11,086	\$14,386	\$117,183	\$119,862
WORD & SACRAMENT		\$5,640	\$7,980	\$6,989	\$9,804	\$7,702	\$6,877	\$53,429	\$86,380
EARLY CHILDHOOD CTR		\$21,464	\$21,772	\$22,527	\$29,841	\$20,954	\$19,797	\$173,347	\$168,173
TOTAL EXPENSES		\$47,975	\$42,076	\$44,119	\$52,743	\$39,742	\$41,060	\$343,989	\$304,453
OFFERINGS		\$25,692	\$26,570	\$18,637	\$15,560	\$26,860	\$18,420	\$175,410	\$160,000
ECC INCOME		\$17,944	\$17,808	\$18,236	\$18,711	\$21,509	\$19,974	\$148,117	\$128,535
ECC GRANT FUNDS		\$20,628	\$13,827	\$0	\$15,408	\$7,102	\$0	\$72,488	\$20,000
TOTAL INCOME		\$64,264	\$58,540	\$36,910	\$49,678	\$60,336	\$38,394	\$401,651	\$350,267
MONTHLY BALANCE		\$16,289	\$16,465	\$7,209	\$3,065	\$20,594	\$2,666	\$57,662	
ECC INCOME/LOSS		\$17,109	\$9,863	\$4,290	\$4,277	\$7,656	\$177		



Lutheran Women in Mission

The Lutheran Women in Mission organization is the longest existing service group in the LCMS. LWML meets on the 2nd Tuesday of each month at 4:00 for a short business meeting and Bible Study from the current LWML Quarterly and fellowship. All women are welcome. For more information call Ruth Valdez at (316) 213-0177. Quilting ladies meet on Tuesdays at 10am and on Saturdays at 9am for quilting and fellowship. So far this year, there have been 135 quilts finished. During the year they also make School Kits, Health Kits and Baby Kits and hold fundraisers.

Sunday, October 1st is LWML Sunday at Bethany. This is a day to recognize our Lutheran Women in Mission. We have a group of ladies who meet twice a week who make quilts for World Relief, and these Quilts will be displayed on the backs of the pews, ladies will be handing out bulletins, ushering and assisting with the readings for the day. We have "mite boxes" located on the LWML table in the Narthex, which can be used by anyone's use to collect loose change or even folding money. These "mites" fund most of LWML's mission projects. The 2023-2025 Mission Grant goal is \$2,350,000. This goal is funded from monies received from MITES!

ON OCTOBER 7th, the Wichita Zone Fall Festival will be held at Ascension Lutheran in Pratt. Mission Speaker will be Brooke Pernice with Lutheran Braille Workers and will present her presentation, "Ministry Through Music". Registration is \$5 and begins at 9AM with snacks and singing, followed with a Bible study led by Kristin Schultz. Join the fun! Recipe Family Feud (between groups). Ingathering Door Offering for Lutheran Braille Workers + Mites, Salad Luncheon and More! Zone Business Meeting 1-2PM. Please RSVP to Ruth Valdez prior to October 1st. We plan to carpool if you wish to attend.

Mission Speaker:
Brooke Pernice
Lutheran Braille Workers



"Ministry Through Music"
Presentation and Special Event:
"Wining in the Dark" (with desserts!)

WE RECEIVED A Thank you letter from MOST MINISTRIES for our donation of eyeglasses. This year Bethany has sent a total of 146 pair of eyeglasses and sunglasses to MOST Ministries and we continue to collect them. They have delivered over 5,300 pairs of eyeglasses to individuals in need of seeing clearly, many for the first time. These people have gone through their clinics who might never have stepped foot in a Christian church, and as they said it is a beautiful moment when you can witness someone hearing about Jesus for the first time and also you hear a loud "WOW" as someone can see clearly for the first time. You know immediately that a life has been changed. Their letter is posted on the bulletin board in the hallway and is very interesting. You may want to take time to read it. We thank you for bringing your used eyeglasses and placing them in the brown box on the LWML table in the Narthex. We continue to collect them as there is always a need for them somewhere in the world!

Second Saturday: Another successful event: cleaning the kitchen and other tasks including putting up signs, checking bells, etc..

The next Cleaning Saturday is scheduled for October 14. We will clean blinds and windows in the Narthex and Sacristy.



Special Music is Back!!!!

Sandy Tope will be directing the Choir and the Bell Choir. Come and join one or both.



Both will meet for practice
on **Wednesday nights.**

Bell Choir at 6:00pm
Choir at 7:00pm

Both will start October 4th.



Fly Fishing Group



On Saturday, Sept 15, we had our latest fly club meeting. We began with fly casting instruction and practice. We also practiced tying two basic knots: the surgeons knot for attaching the leader to the tippet and the clinch knot for attaching the tippet to the fly.

Due to scheduling conflicts, we have moved the October meeting to the first Saturday, Oct. 7 at 9am. The activity for this meeting is fly tying. The flies tied will be used in the November meeting.

The November meeting on Saturday, Nov. 18, will be an outing to Pratt Centennial Pond in Pratt. We will meet at Bethany at 7:30am and carpool to the site. For most of the people this will be their first fly fishing experience. If you plan on joining us you will need to pack a lunch.

Any questions, please talk with Doug, Robert or Dwan (dwan@mpmlc.net)



Let's go fishing!

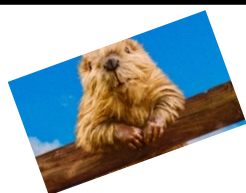

Movie Night

"Family Camp"

A faith-based family comedy.

Saturday, October 14th. 6:30pm

In the Activity Center

Snacks provided

A SKIT GUYS MOVIE



Groundbreaking Service



Original members lead the procession. All ages used the shovels to be a part of the groundbreaking. It was an exciting day!
The future looks bright.





Movie Night
Saturday, October
14th, 6:30pm
See page 8 for
more info.

A SKIT GUYS MOVIE

ECC
Trunk or Treat
October 26th
Watch for
more Info

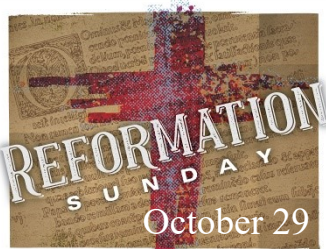

Sunday Mornings
Service at 9:00 AM
(also online: Facebook Live)
Fellowship time:
10:00AM to 10:30AM
Sunday School/Bible Study
10:30AM to 11:30AM

Church Office Hours
Open: 8:30am
Closed for Lunch:
12:00p.m. - 1:00p.m.
Closed: 5:00 p.m.



Bethany Lutheran Church and School
1000 W 26th St. South
Wichita, KS 67217



Like us on Facebook!
Bethany Lutheran
Church & Early
Childhood Center

